

DN1020

POWER SUPPLY/24VDC/1.3A

Evaluation systems, power supplies

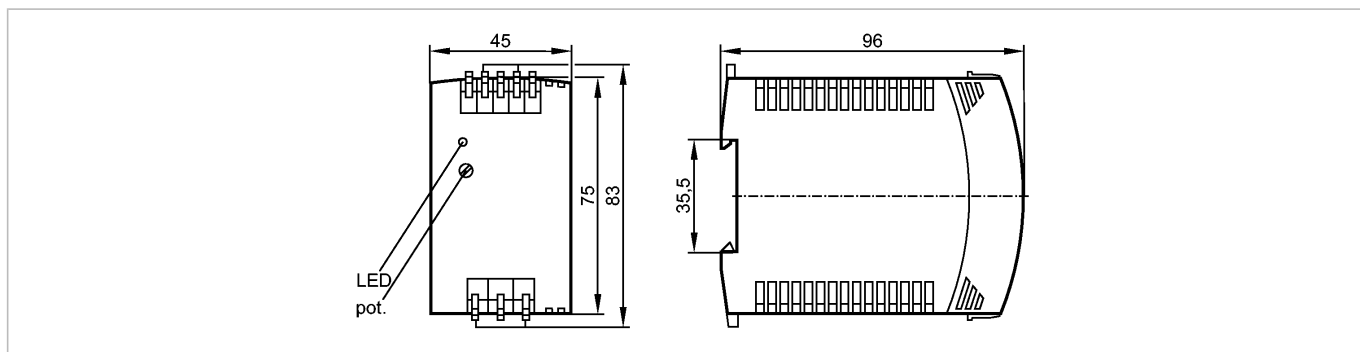

Product characteristics

Switched-mode power supply 24 V DC
Primary switched mode
30 W power output

Application

Application	regulated power supply for sensors, actuators, evaluation electronics and plcs
-------------	--

Electrical data

Input voltage range	[V]	100...240 AC
Nominal voltage	[V]	115 / 230 AC
Nominal frequency	[Hz]	50...60
Output voltage	[V]	24...28 DC ($\pm 2\%$) *) to SELV/PELV
Output current	[A]	1.3
Residual ripple	[mV]	< 50
Efficiency	[%]	87.5 (230 V AC; 24 V DC / 1.3 A)
Short-circuit protection		yes
Overload protection		yes
Overvoltage protection	[V]	< 40
Derating	[W/K]	1 (60...70 °C)
Mains buffering time	[ms]	> 190 (230 V AC; 24 V DC / 1.3 A)
Protection class		I

Outputs

Output	30 W power output
--------	-------------------

Environment

Ambient temperature	[°C]	-10...70
Protection		IP 20

Tests / approvals

EMC		EN 61000-6-2 EN 61000-6-3
MTTF	[Years]	411

Mechanical data

Housing materials		polycarbonate
Installation		rail TH35 (to EN 60715)
Weight	[kg]	0.311

Displays / operating elements

Function display	LED	green
------------------	-----	-------



DN1020

POWER SUPPLY/24VDC/1.3A

Evaluation systems, power supplies

Electrical connection

Connection

spring clamp terminals up to 2.5 mm²

Wiring

1: primary, 2: secondary

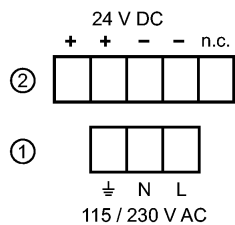

Remarks

Remarks

*) adjustable
Protection class according to IEC 61140

Pack quantity

[piece]

1