

NS5002

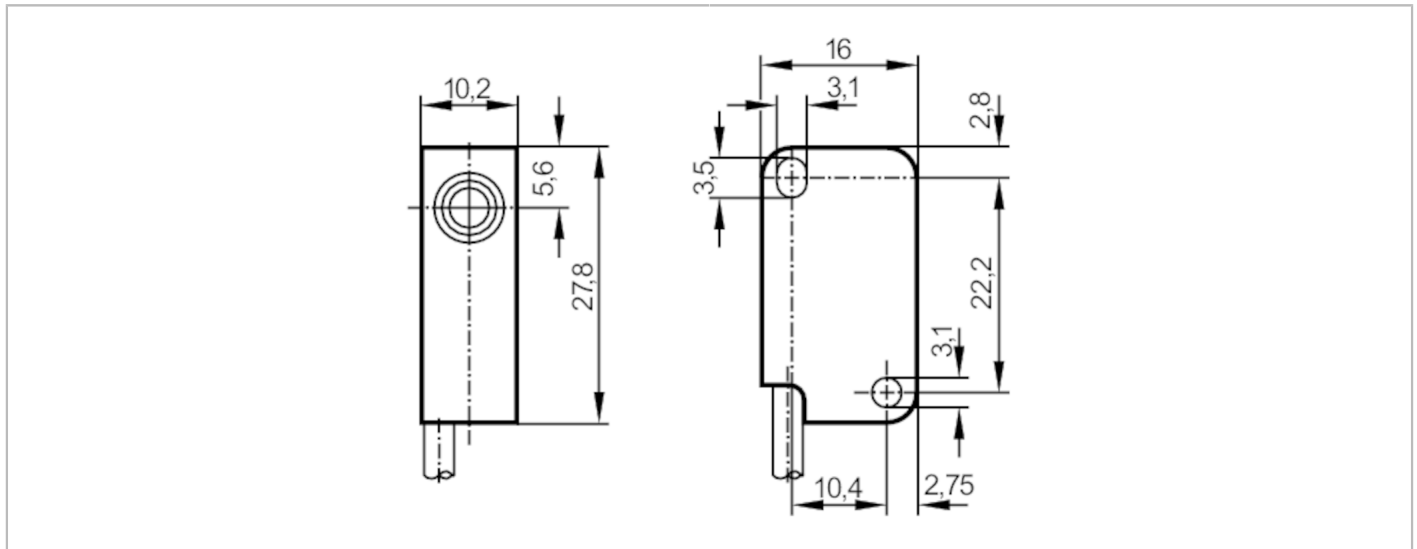

Inductive NAMUR sensor

IS-2002-NOLED/1D/1G



Product characteristics	
Electrical design	NAMUR
Output function	normally closed
Sensing range [mm]	2
Housing	rectangular
Dimensions [mm]	28 x 10 x 16
Electrical data	
Connection at circuit amplifier	yes
Switching amplifiers	connection to certified intrinsically safe circuits with the max. values: U = 15 V / I = 50 mA / P = 120 mW
Nominal voltage DC [V]	8.2; (1kΩ)
Supply voltage DC [V]	7.5...30; (when used outside the hazardous area)
Current consumption [mA]	< 1; (disabled; conductive: > 2,1)
Outputs	
Electrical design	NAMUR
Output function	normally closed
Permanent current rating of switching output DC [mA]	30; (when used outside the hazardous area)
Switching frequency DC [Hz]	800
Monitoring range	
Sensing range [mm]	2
Real sensing range Sr [mm]	2 ± 10 %
Accuracy / deviations	
Correction factor	steel: 1 / stainless steel: 0.7 / brass: 0.5 / aluminum: 0.4 / copper: 0.3
Hysteresis [% of Sr]	1...15
Switch-point drift [% of Sr]	-10...10

NS5002



Inductive NAMUR sensor

IS-2002-NOLED/1D/1G

Operating conditions		
Ambient temperature	[°C]	-20...70
Protection		IP 67
Tests / approvals		
Approval		PTB 01 ATEX 2191; BVS 04 ATEX E153; IECEx BVS 06.0003
ATEX marking		Ex II 1G Ex ia IIB T6 Ga
		Ex II 2G Ex ia IIC T6 Gb
		Ex II 1D Ex ia IIIC T 90°C Da
EMC		EN 60947-5-6
Shock/vibration resistance		30 g (11 ms) / 10-55 Hz (1 mm)
MTTF	[years]	4776
Safety classification		
Max. internal capacitance	[nF]	80
Max. internal inductance	[μH]	110
Mechanical data		
Weight	[g]	85
Housing		rectangular
Mounting		flush mountable
Dimensions	[mm]	28 x 10 x 16
Material		PBT
Remarks		
Pack quantity		1 pcs.
Electrical connection		
Cable: 2 m, PVC; 2 x 0.14 mm ²		

Connection

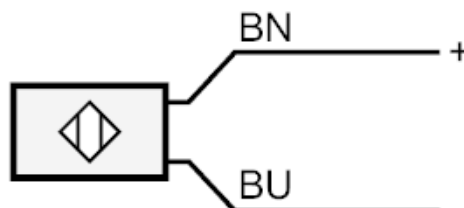

Core colors :

BN = brown
BU = blue