

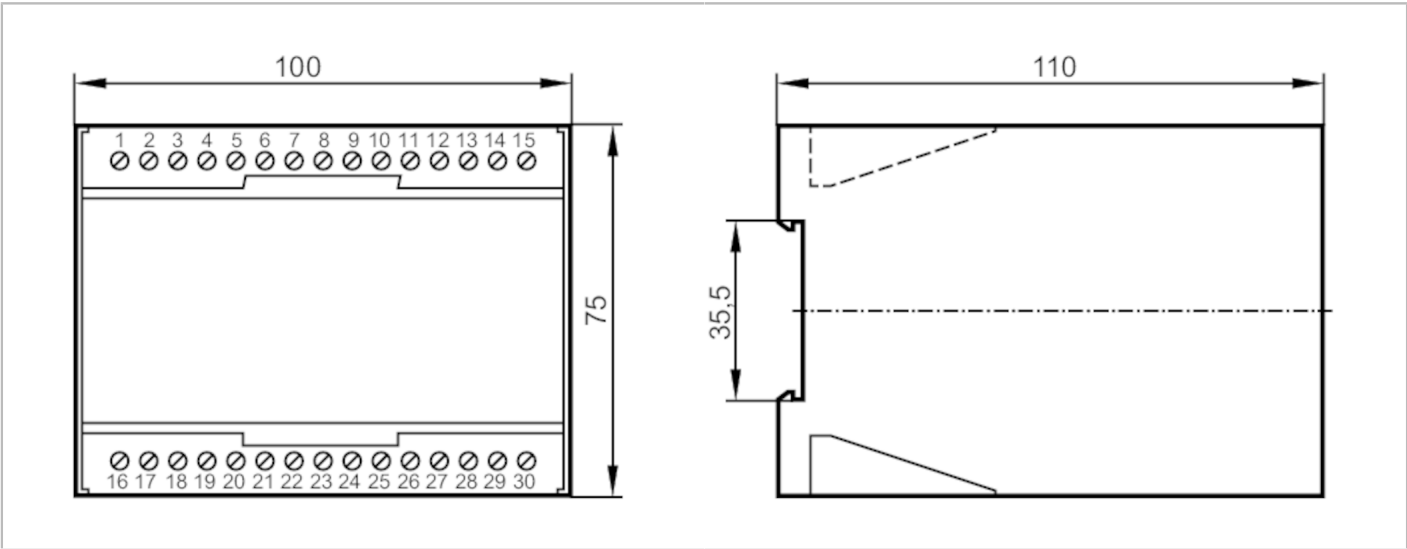

Evaluation unit for skew monitoring

C230/230VAC

Article no longer available - archive entry



Product characteristics		
Housing		housing for DIN rail mounting
Dimensions	[mm]	75 x 100 x 110
Application		
Application		monitoring the belt with 2 sensors each at the ends of the bucket conveyor with regard to misalignment; skew monitoring on bucket conveyors to prevent belt wear and subsequent damage
Electrical data		
Nominal voltage AC	[V]	< 230
Nominal voltage DC	[V]	24
Nominal voltage tolerance	[%]	10
Nominal voltage tolerance 2	[%]	10
Nominal frequency AC	[Hz]	47...63
Auxiliary energy for sensors DC	[V]	24
Inputs / outputs		
Number of inputs and outputs		Number of relay outputs: 2
Outputs		
Number of relay outputs		2
Contact rating		6 A / 1000 VA / 250 V AC
Software / programming		
Adjustment of the switch point		potentiometer
Operating conditions		
Ambient temperature	[°C]	0...50
Protection		IP 40
Protection rating terminals		IP 20



Evaluation unit for skew monitoring

C230/230VAC

Tests / approvals		
MTTF	[years]	289
Mechanical data		
Weight	[g]	624
Housing		housing for DIN rail mounting
Dimensions	[mm]	75 x 100 x 110
Material		plastics
Displays / operating elements		
Display	Switching status	2 x LED, red
	input signal	4 x LED, green
	fault	4 x LED, red

Evaluation unit for skew monitoring

C230/230VAC

Electrical connection

terminals: ...2.5 mm²

Connection

